

AC-DC Charger Adaptor
GC06E series

- Features :
- Universal AC input / Full range
- 2 pole EURO plug
- Class II power (without earth pin)
- Protections: Short circuit / Over load / Over voltage
- No load power consumption <0.75W
- Pass LPS
- Fully enclosed plastic case
- Approvals: TUV / CB / CE
- 1 year warranty

SPECIFICATION

ORDER NO.	GC06E-0P1J	GC06E-1P1J	GC06E-11P1J	GC06E-2P1J	GC06E-4P1J	
OUTPUT	SAFETY MODEL NO.	GPSU06-0-CC	GPSU06-1-CC	GPSU06-1-1-CC	GPSU06-2-CC	GPSU06-4-CC
	DC VOLTAGE Note.2	3V	5.6V	7.2V	8.4V	14.3V
	RATED CURRENT	1.33A	0.89A	0.83A	0.71A	0.41A
	CURRENT RANGE	0 ~ 1.33A	0 ~ 0.89A	0 ~ 0.83A	0 ~ 0.71A	0 ~ 0.41A
	RATED POWER	4W	5W	6W	6W	6W
	RIPPLE & NOISE (max.) Note.3	50mVp-p	50mVp-p	80mVp-p	80mVp-p	100mVp-p
	VOLTAGE ADJ. RANGE	Fixed				
	VOLTAGE TOLERANCE Note.4	±5.0%	±5.0%	±5.0%	±5.0%	±3.0%
	LINE REGULATION Note.5	±1.0%	±0.5%	±0.5%	±0.5%	±0.5%
LOAD REGULATION Note.6	±5.0%	±5.0%	±5.0%	±5.0%	±3.0%	
SETUP, RISE, HOLD TIME	200ms, 50ms, 16ms at full load					
INPUT	VOLTAGE RANGE	90 ~ 264VAC 135 ~ 370VDC				
	FREQUENCY RANGE	47 ~ 63Hz				
	EFFICIENCY (Typ.) Note.7	45%	60%	65%	70%	75%
	AC CURRENT	0.3A / 100VAC				
	INRUSH CURRENT (max.)	30A / 230VAC				
LEAKAGE CURRENT(max.)	0.25mA / 240VAC					
PROTECTION	OVER LOAD	105 ~ 200% rated output power Protection type : Constant current limiting, recovers automatically after fault condition is removed				
	OVER VOLTAGE	110 ~ 140% rated output voltage Protection type : Clamp by zener diode				
ENVIRONMENT	WORKING TEMP.	0 ~ +50°C (Refer to output load derating curve)				
	WORKING HUMIDITY	20% ~ 90% RH non-condensing				
	STORAGE TEMP., HUMIDITY	-20 ~ +85°C, 10 ~ 95% RH				
	TEMP. COEFFICIENT	±0.03% / °C (0 ~ 50°C)				
	VIBRATION	10 ~ 500Hz, 2G 10min./1cycle, period for 60min. each along X, Y, Z axes				
SAFETY & EMC (Note. 8)	SAFETY STANDARDS	EN60950-1 Approved				
	WITHSTAND VOLTAGE	I/P-O/P:4242VDC				
	ISOLATION RESISTANCE	I/P-O/P:100M Ohms / 500VDC				
	EMI CONDUCTION & RADIATION	Compliance to EN55022 class B				
	HARMONIC CURRENT	Compliance to EN61000-3-2,3				
OTHERS	EMM IMMUNITY	Compliance to EN61000-4-2,3,4,5,6,11, Light industry level, criteria A				
	MTBF	50Khrs min. MIL-HDBK-217F(25°C)				
CONNECTOR	DIMENSION	32*66*42.5mm (L*W*H)				
	PACKING	100g ; 90pcs / 10Kg / CARTON				
	PLUG	Standard type P1J: 2.1φ * 5.5φ * 11mm, tuning fork type center positive for stock ; Other type available by customer requested				
NOTE	CABLE	Standard type 20Awg UL1185 6ft for stock ; Other type available by customer requested				
	NOTE	1.All parameters are specified at 230VAC input, rated load, 25°C 70% RH. Ambient. 2.DC voltage: The output voltage set at point measure by plug terminal & 50% load. 3.Ripple & noise are measured at 20MHz by using a 12" twisted pair terminated with a 0.1uf & 47uf capacitor. 4.Tolerance: includes set up tolerance, line regulation, load regulation. 5.Line regulation is measured from low line to high line at rated load. 6.Load regulation is measured from 0% to 100% rated load 7.Efficiency is measured at 230VAC. 8.The power supply is considered a component which will be installed into a final equipment. The final equipment must be re-confirmed that it still meets EMC directives.				



AC-DC Charger Adaptor

GC06E series

Mechanical Specification

Unit:mm

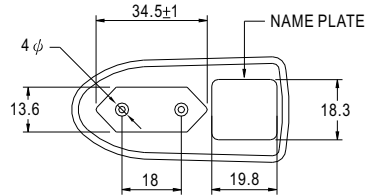

Plug Assignment

Standard plug: P1J (option)

P1J	
P/N	OUTPUT
CENTER	+

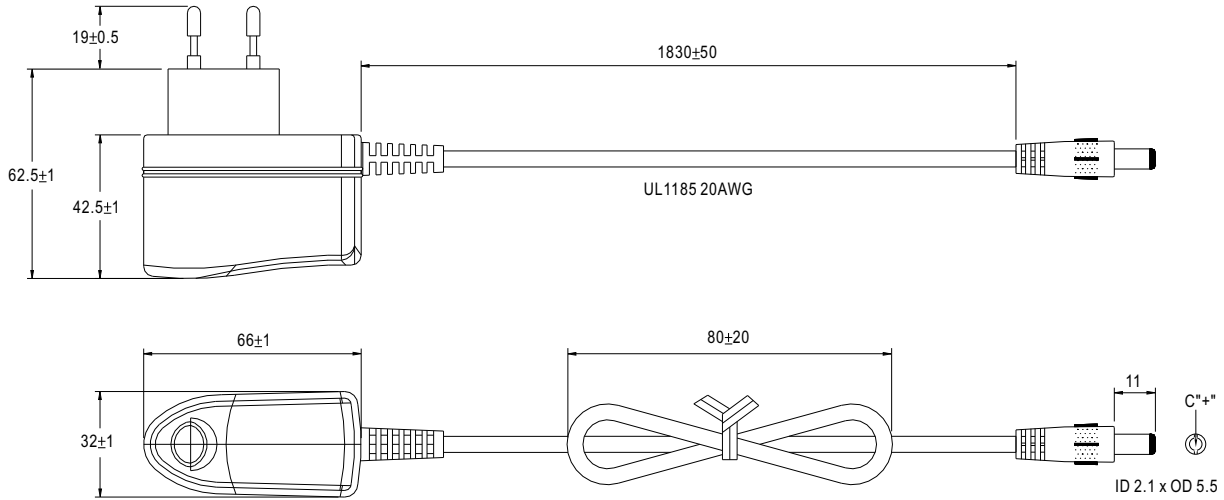

Charging Curve

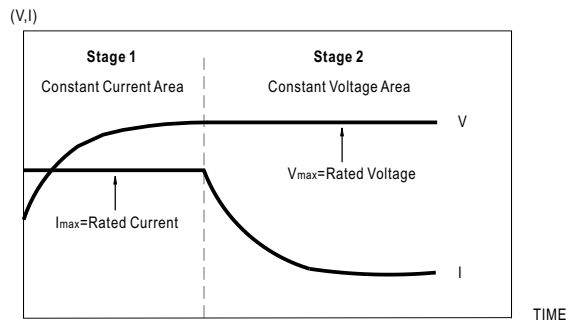

Plug Assignment

Standard plug: P1J (option)

P1J	
P/N	OUTPUT
CENTER	+

Derating Curve

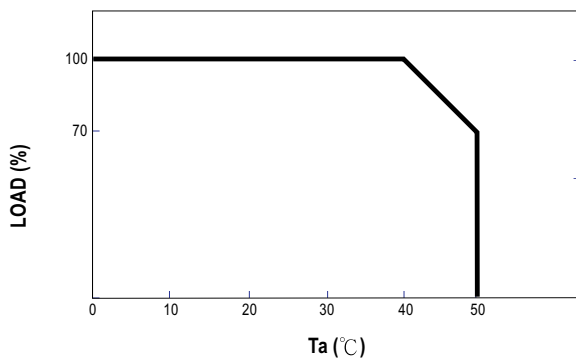

Static Characteristics

